

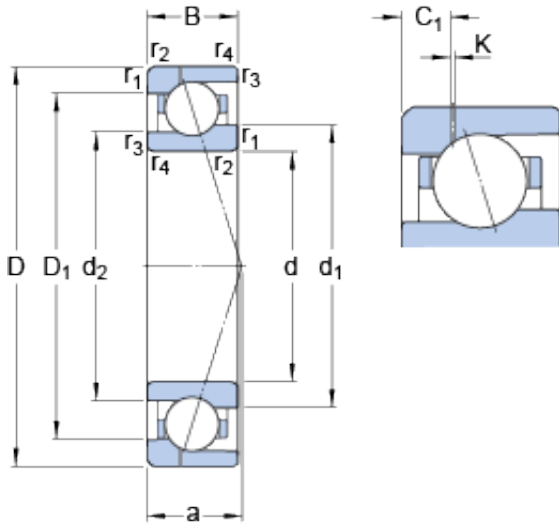

# NTA PRECISION AXLE CORP.



## 60 mm x 85 mm x 13 mm SKF 71912 ACE/P4AH1 angular contact ball bearings

Bearing No. 71912 ACE/P4AH1

71912 ACE/P4AH1 Bearing 2D drawings and 3D CAD models

Size	85x60x13 mm
Bore Diameter	85 mm
Outer Diameter	60 mm
Width	13 mm
d	60 mm
D	85 mm
B	13 mm
d <sub>1</sub>	67.75 mm
d <sub>2</sub>	65.7 mm
D <sub>1</sub>	77.3 mm
K	0.5 mm
C <sub>1</sub>	3.83 mm
r <sub>1,2</sub> - min.	1 mm
r <sub>3,4</sub> - min.	0.3 mm
a	24.6 mm
d <sub>a</sub> - min.	64.6 mm
d <sub>b</sub> - min.	62 mm
D <sub>a</sub> - max.	80.4 mm
D <sub>b</sub> - max.	83 mm
r <sub>a</sub> - max.	1 mm
r <sub>b</sub> - max.	0.3 mm
d <sub>n</sub>	69.6 mm
Basic dynamic load rating - C	15.3 kN
Basic static load rating - C <sub>0</sub>	11.2 kN



## NTA PRECISION AXLE CORP.

Fatigue load limit - $P_u$	0.475 kN
Limiting speed for grease lubrication	19500 r/min
Limiting speed for oil lubrication	30000 mm/min
Ball - $D_w$	7.938 mm
Ball - $z$	23
$G_{ref}$	2.5 cm <sup>3</sup>
Calculation factor - $e$	0.68
Calculation factor - $Y_2$	0.87
Calculation factor - $Y_0$	0.38
Calculation factor - $X_2$	0.41
Calculation factor - $Y_1$	0.92
Calculation factor - $Y_2$	1.41
Calculation factor - $Y_0$	0.76
Calculation factor - $X_2$	0.67
Preload class A - $G_A$	139 N
Preload class B - $G_B$	418 N
Preload class C - $G_C$	836 N
Calculation factor - $f$	1.13
Calculation factor - $f_1$	0.99
Calculation factor - $f_{2A}$	1
Calculation factor - $f_{2B}$	1.04
Calculation factor - $f_{2C}$	1.07
Calculation factor - $f_{HC}$	1
Preload class A	115 N/micron
Preload class B	173 N/micron
Preload class C	228 N/micron
$d_1$	67.75 mm
$d_2$	65.7 mm



## NTA PRECISION AXLE CORP.

$D_1$	77.3 mm
$C_1$	3.83 mm
$r_{1,2}$ min.	1 mm
$r_{3,4}$ min.	0.3 mm
$d_a$ min.	64.6 mm
$d_b$ min.	62 mm
$D_a$ max.	80.4 mm
$D_b$ max.	83 mm
$r_a$ max.	1 mm
$r_b$ max.	0.3 mm
$d_n$	69.6 mm
Basic dynamic load rating C	15.3 kN
Basic static load rating $C_0$	11.2 kN
Fatigue load limit $P_u$	0.475 kN
Attainable speed for grease lubrication	19500 r/min
Attainable speed for oil-air lubrication	30000 r/min
Ball diameter $D_w$	7.938 mm
Number of balls z	23
Reference grease quantity $G_{ref}$	2.5 cm <sup>3</sup>
Preload class A $G_A$	139 N
Static axial stiffness, preload class A	115 N/ $\mu$ m
Preload class B $G_B$	418 N
Static axial stiffness, preload class B	173 N/ $\mu$ m
Preload class C $G_C$	836 N
Static axial stiffness, preload class C	228 N/ $\mu$ m
Calculation factor f	1.13
Calculation factor $f_1$	0.99
Calculation factor $f_{2A}$	1



## NTA PRECISION AXLE CORP.

Calculation factor $f_{2B}$	1.04
Calculation factor $f_{2C}$	1.07
Calculation factor $f_{HC}$	1
Calculation factor $e$	0.68
Calculation factor (single, tandem) $Y_2$	0.87
Calculation factor (single, tandem) $Y_0$	0.38
Calculation factor (single, tandem) $X_2$	0.41
Calculation factor (back-to-back, face-to-face) $Y_1$	0.92
Calculation factor (back-to-back, face-to-face) $Y_2$	1.41
Calculation factor (back-to-back, face-to-face) $Y_0$	0.76
Calculation factor (back-to-back, face-to-face) $X_2$	0.67
Mass bearing	0.19 kg